

Yoghurt Pot Frog

Supplies

- 2 small yoghurt pots
- Green tissue paper
- Pink, green and red card
- Googly eyes
- PVA glue
- Sticky tape
- Black felt-tip pen

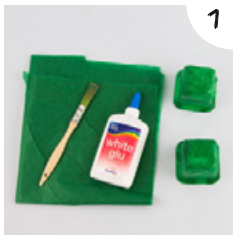

- 1 Use the PVA glue to stick pieces of green tissue paper to the outside of the yoghurt pots. Do this until they are completely covered, then leave to dry.



- 5 Next add the feet to the bottom of the pot, sticking them on using glue. Leave to dry.



- 2 Now work on the bottom part of the frog. Cut out a square of pink card that is slightly smaller than the rim of the yoghurt pot. Also cut out a tongue shape from the red card and two frog feet from the green card.



- 6 Then work on the yoghurt pot that will form the top of the frog. First turn the yoghurt pot upside down, stick googly eyes on and then add some nostrils using the black felt-tip pen.



- 3 Cover the edges of the yoghurt pot top with glue and stick on the square of pink card, then leave to dry.



- 7 Finally, using sticky tape, join the two pots together along the back edge. This should create a hinge for the mouth. Then trim off the excess tape.



- 4 Stick the tongue onto the pink card so that it sticks out over the edge of the pot.

Yoghurt Pot Frog



Supplies

- 2 small yoghurt pots
- Green tissue paper
- Pink, green and red card
- Googly eyes
- PVA glue
- Sticky tape
- Black felt-tip pen





Step 1. Use the PVA glue to stick pieces of green tissue paper to the outside of the yoghurt pots. Do this until they are completely covered, then leave to dry.



Step 2. Now work on the bottom part of the frog. Cut out a square of pink card that is slightly smaller than the rim of the yoghurt pot. Also cut out a tongue shape from the red card and two frog feet from the green card.



Step 3. Cover the edges of the yoghurt pot top with glue and stick on the square of pink card, then leave to dry.



Step 4. Stick the tongue onto the pink card so that it sticks out over the edge of the pot.



Step 5. Next add the feet to the bottom of the pot, sticking them on using glue. Leave to dry.



Step 6. Then work on the yoghurt pot that will form the top of the frog. First turn the yoghurt pot upside down, stick googly eyes on and then add some nostrils using the black felt-tip pen.



Step 7. Finally, using sticky tape, join the two pots together along the back edge. This should create a hinge for the mouth. Then trim off the excess tape.